

ESQUEMA DE INSTALAÇÃO DA COIFA E EXAUSTORES NA COZINHA - PLANTA SEM ESCALA

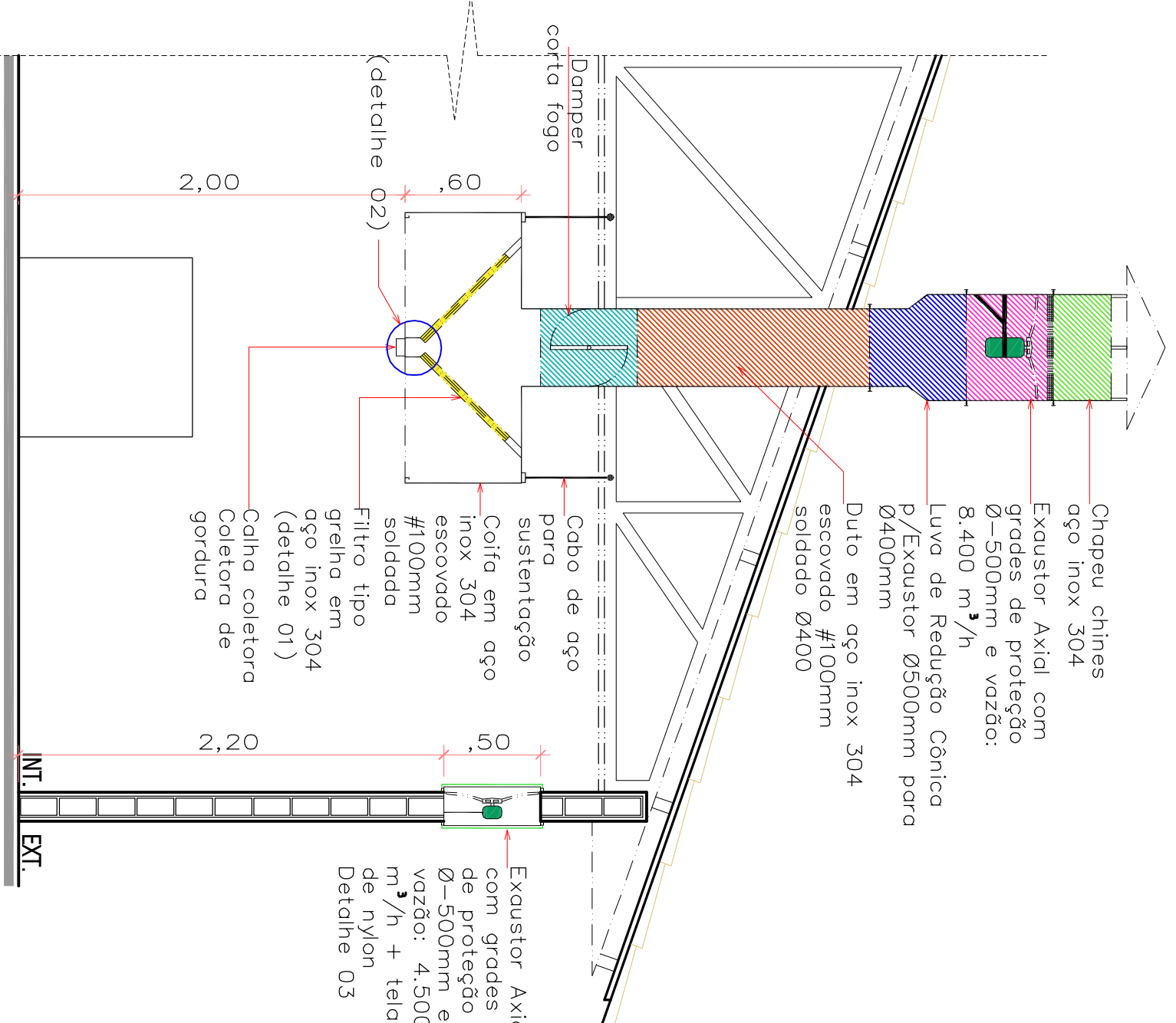

ESQUEMA DE INSTALAÇÃO DA COIFA E EXAUSTORES NA COZINHA -
CORTE AA
SEM ESCALA

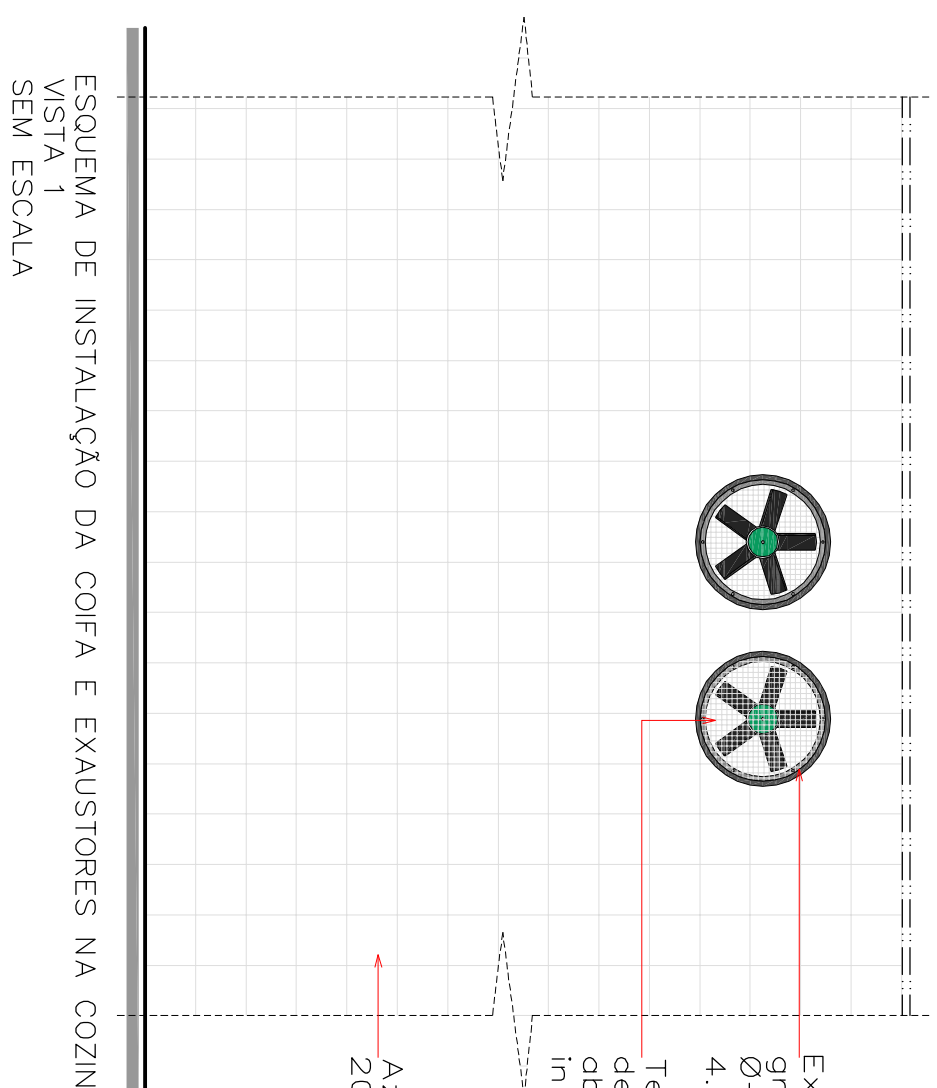

ESQUEMA DE INSTALAÇÃO DA COIFA E EXAUSTORES NA COZINHA -
VISTA 1
SEM ESCALA

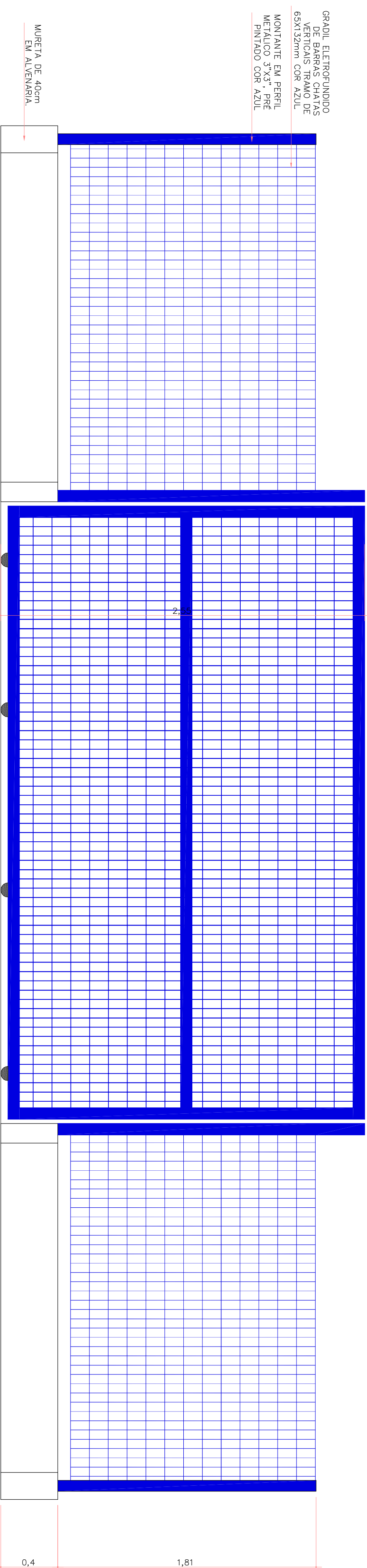

VISTA FRONTAL DO GRADIL COM O PORTÃO
ESCALA: 1/20

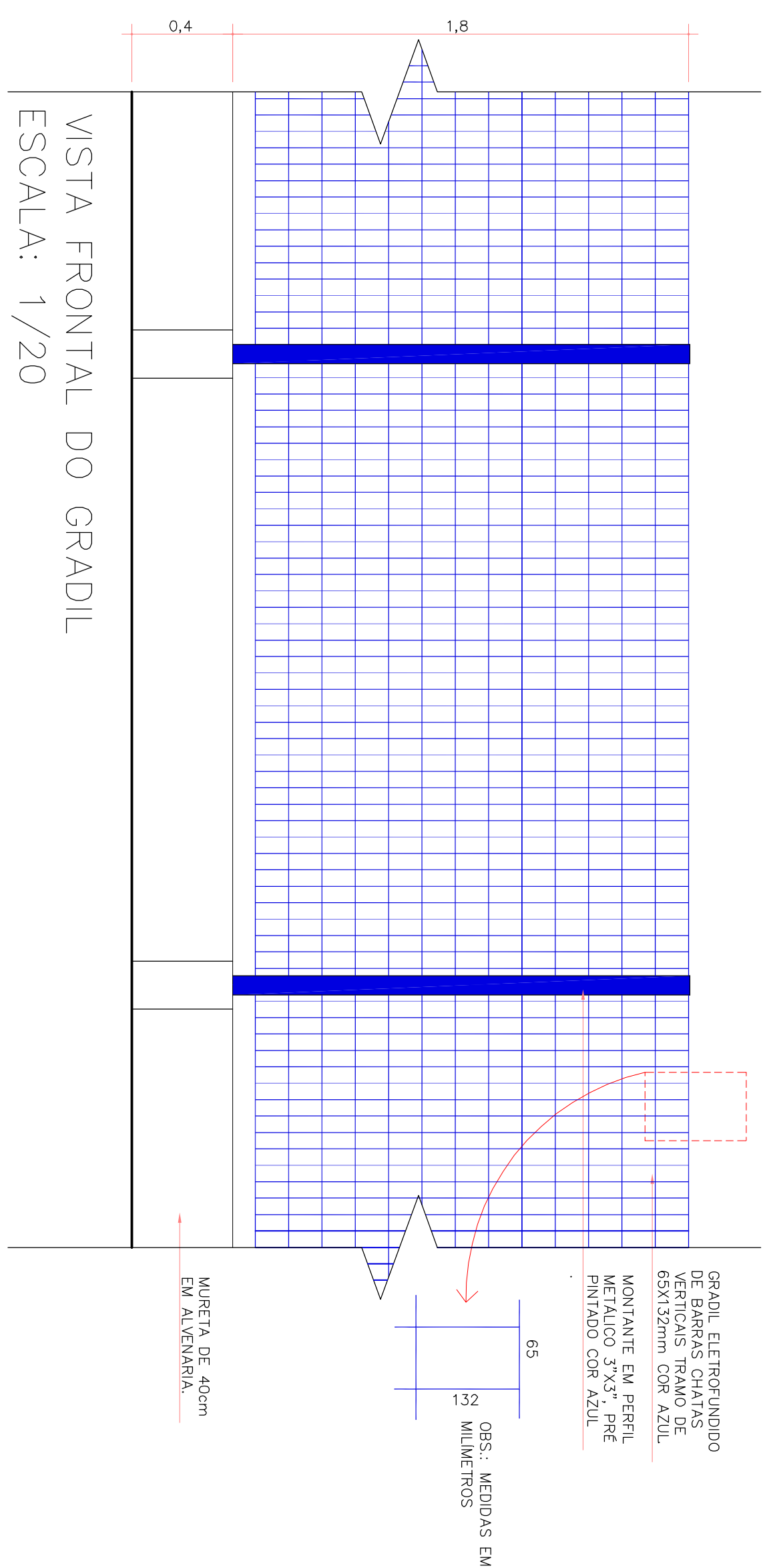

VISTA FRONTAL DO GRADIL
ESCALA: 1/20

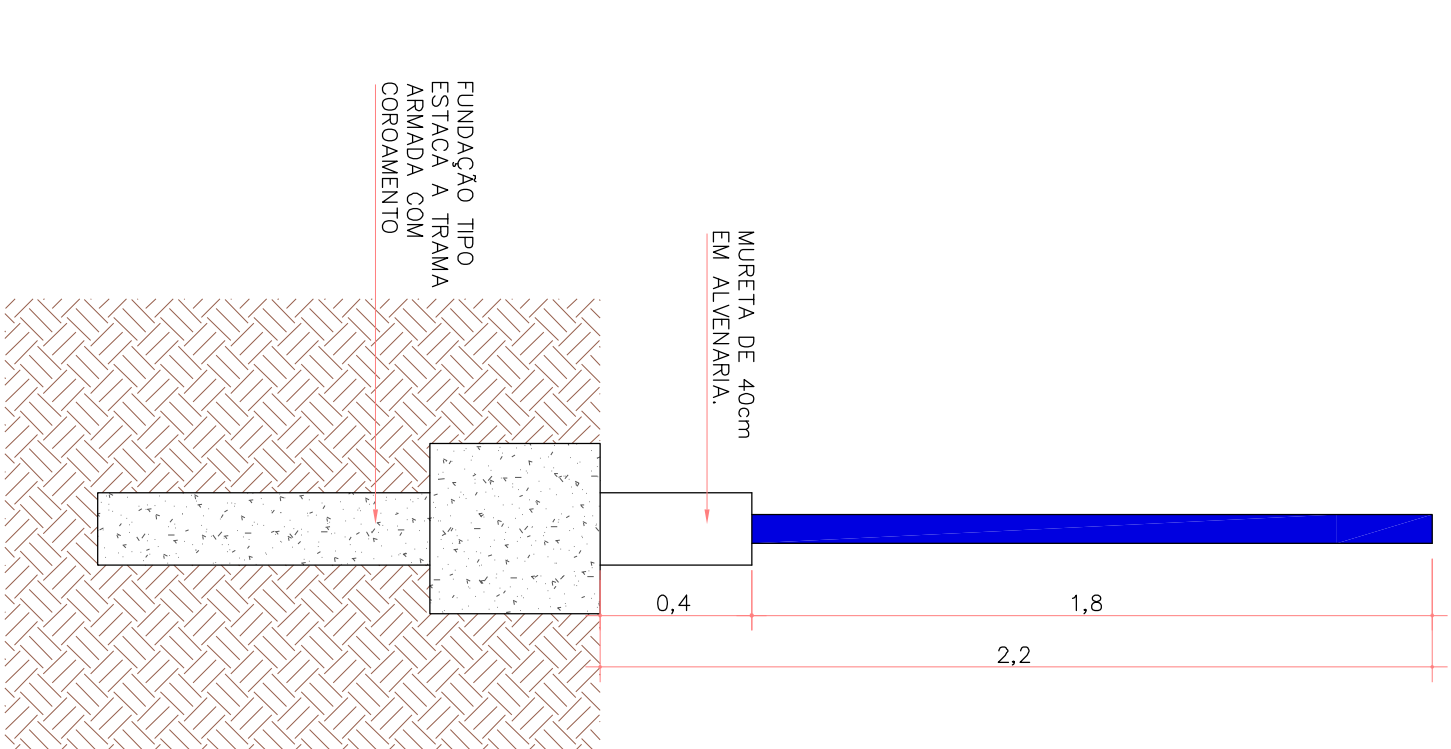

CORTE DO GRADIL
ESCALA: 1/20

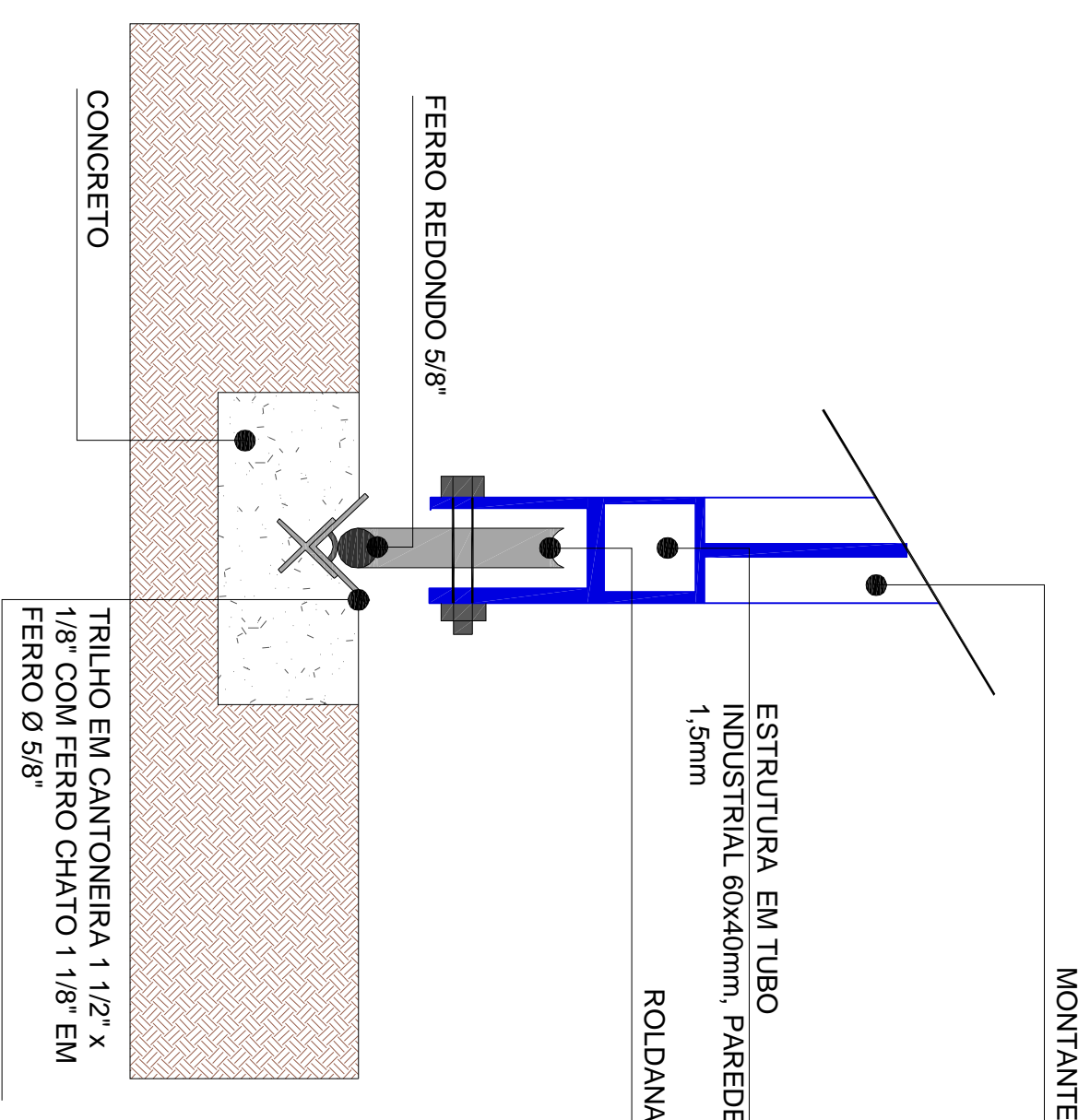

DETALHE DO PORTÃO SEM ESCALA

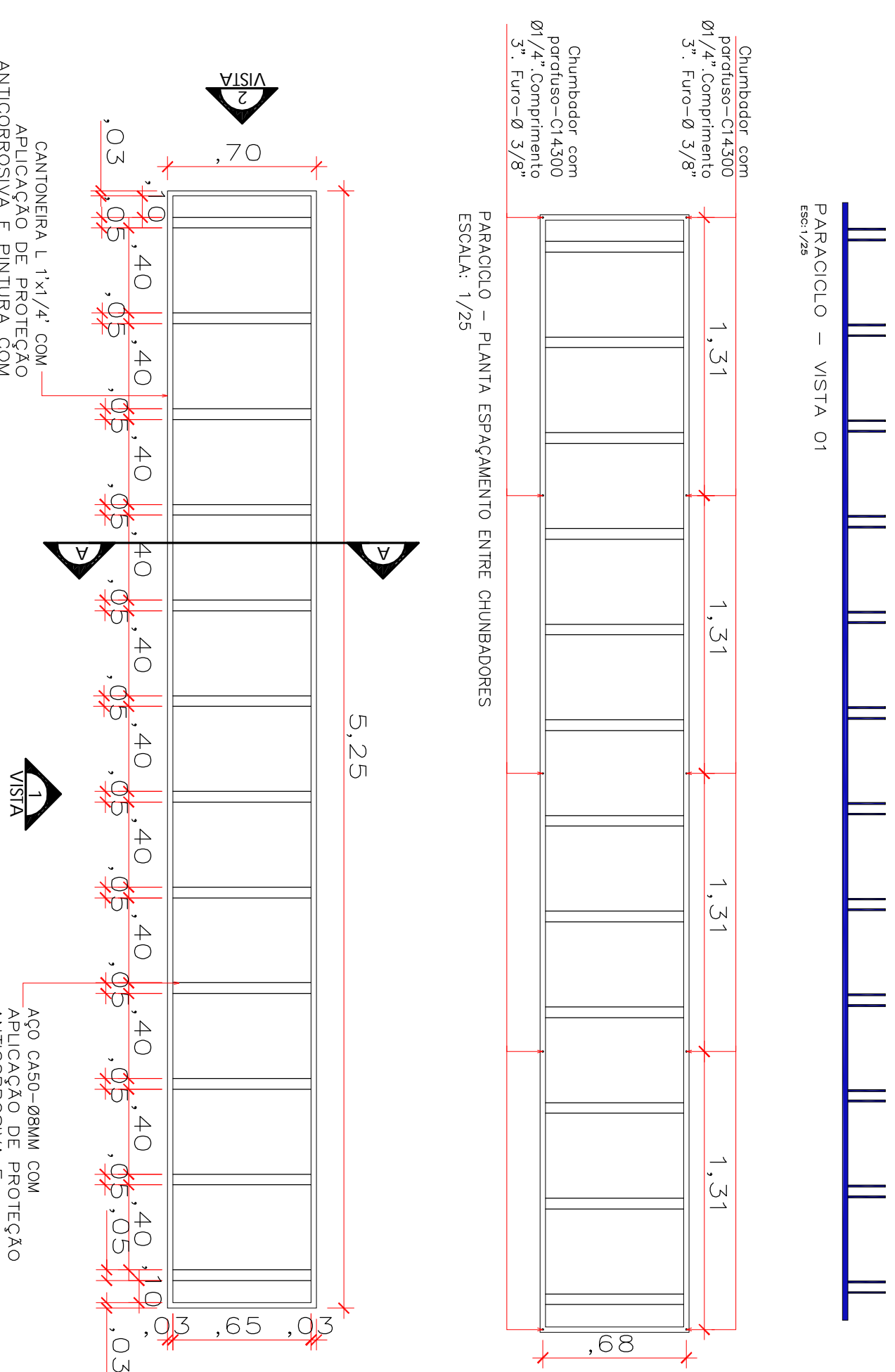

PARACILO - PLANTA ESPAÇAMENTO ENTRE CHUNBADO
ESCALA: 1/25

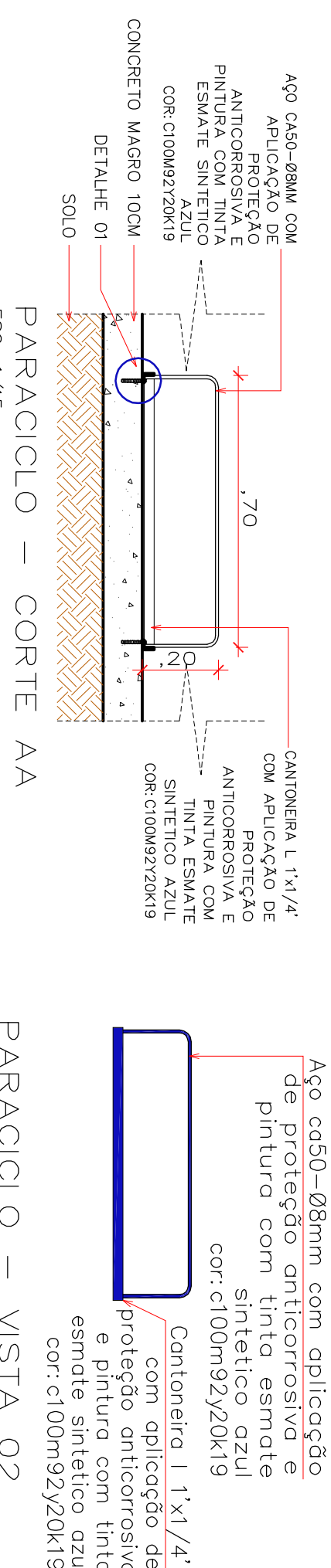

PARACICLO - CORTE A

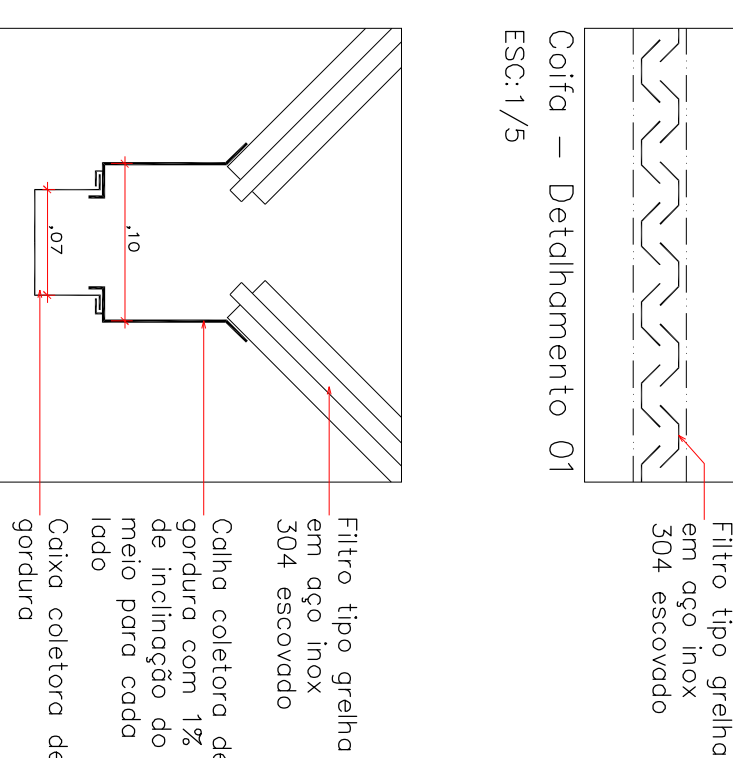
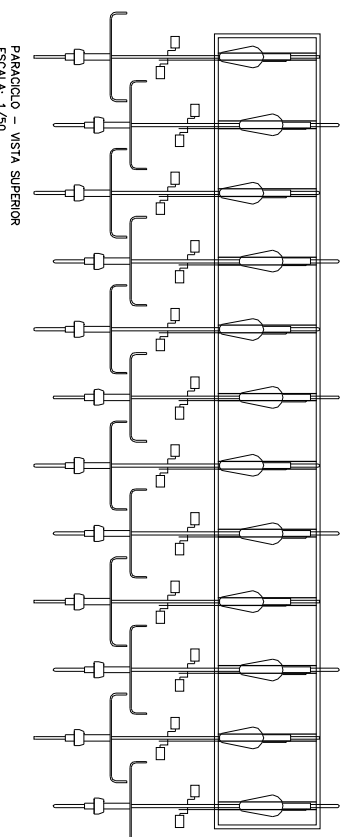
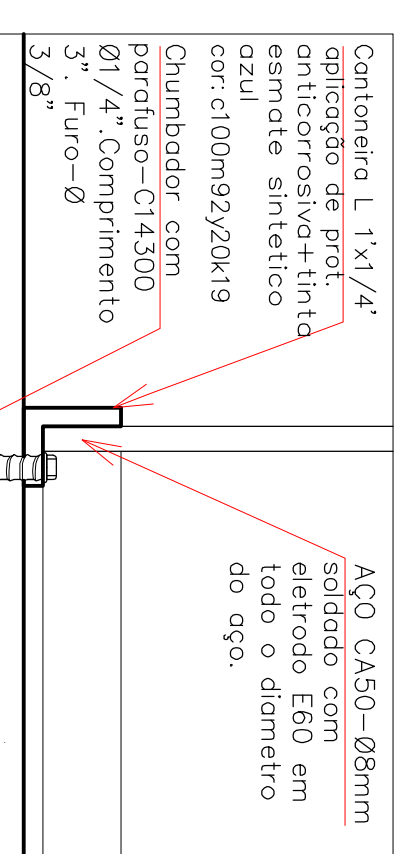

ESC:1/2

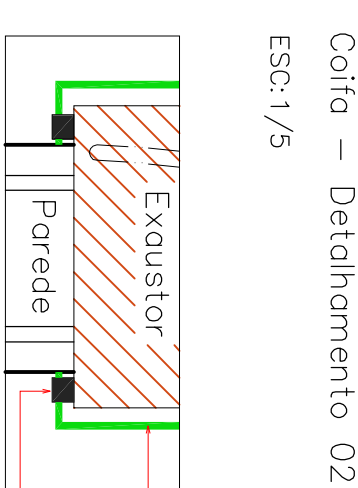

ESC:1/9



ESC:1/9

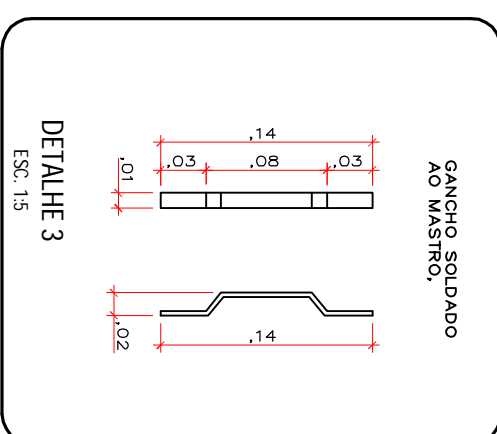
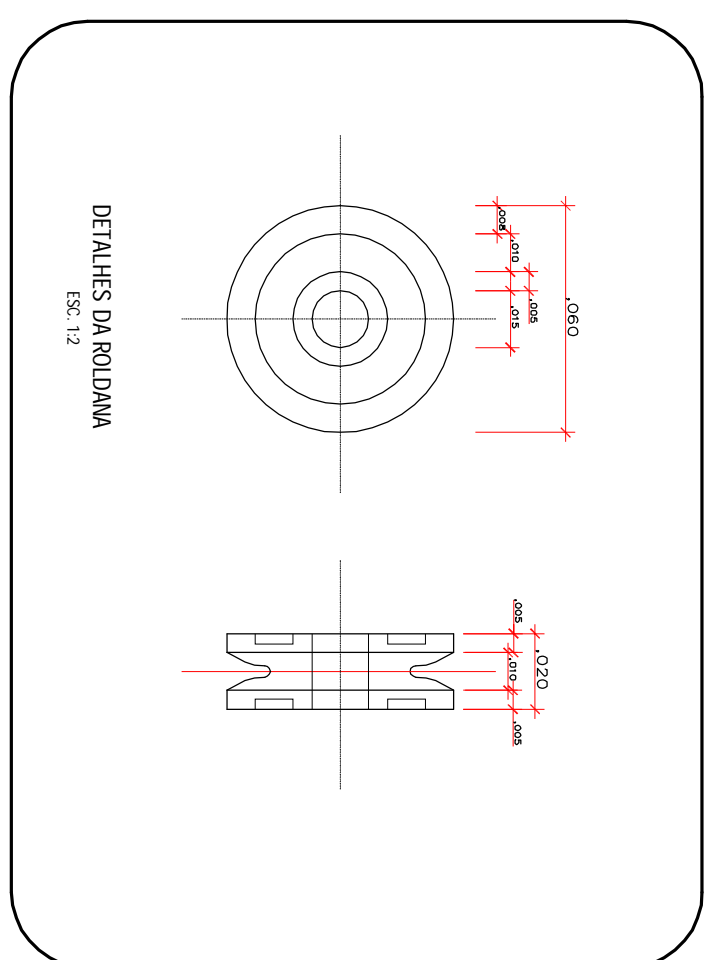
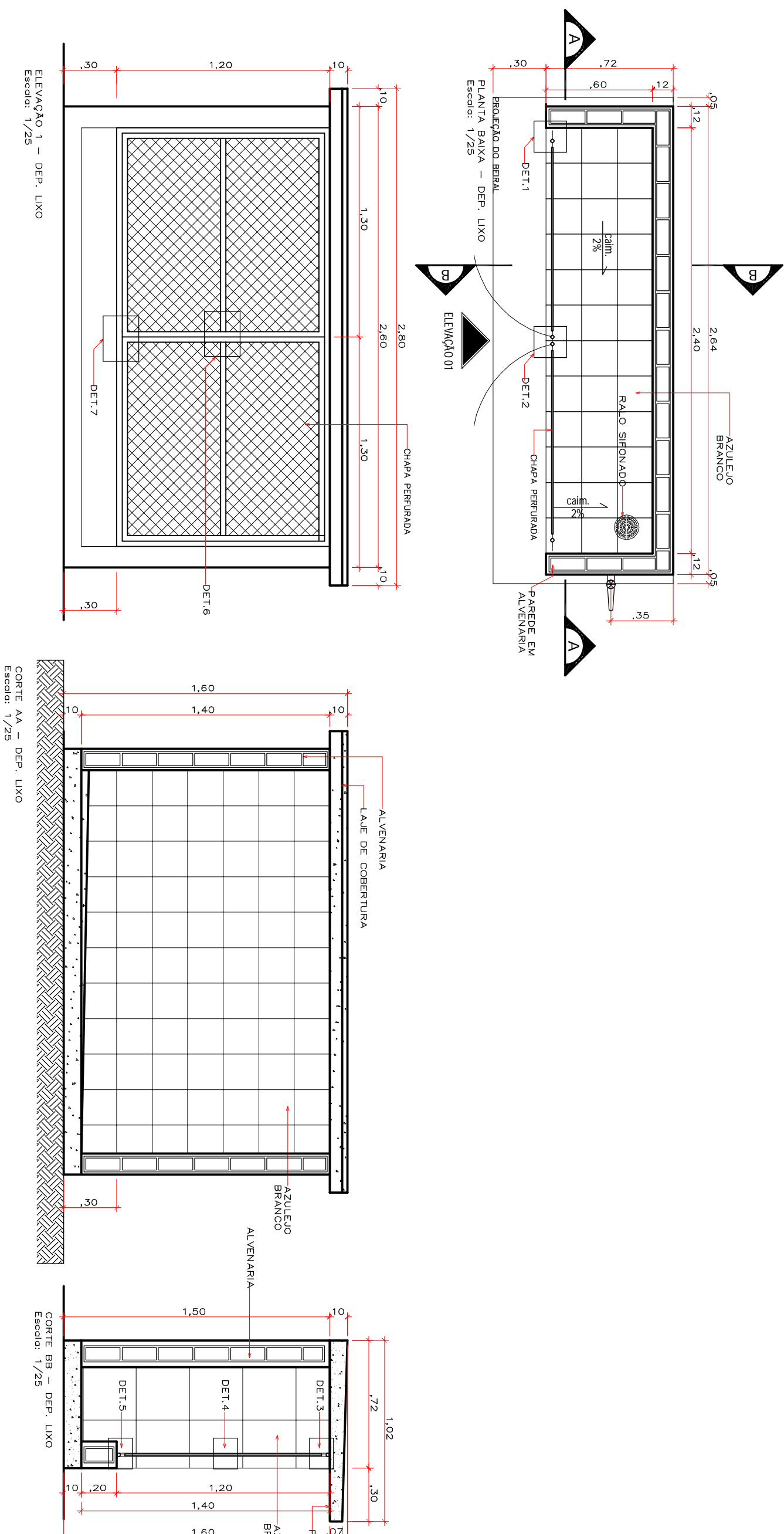

DETAILHE
ESC. 1/5

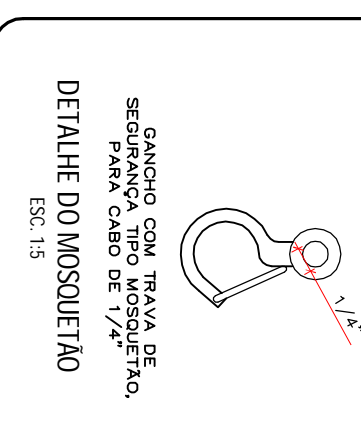

[59]

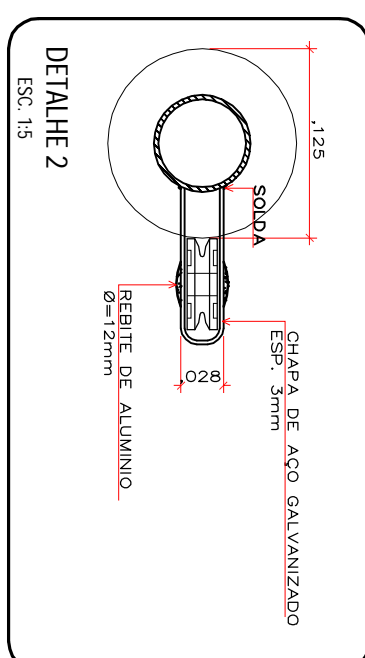
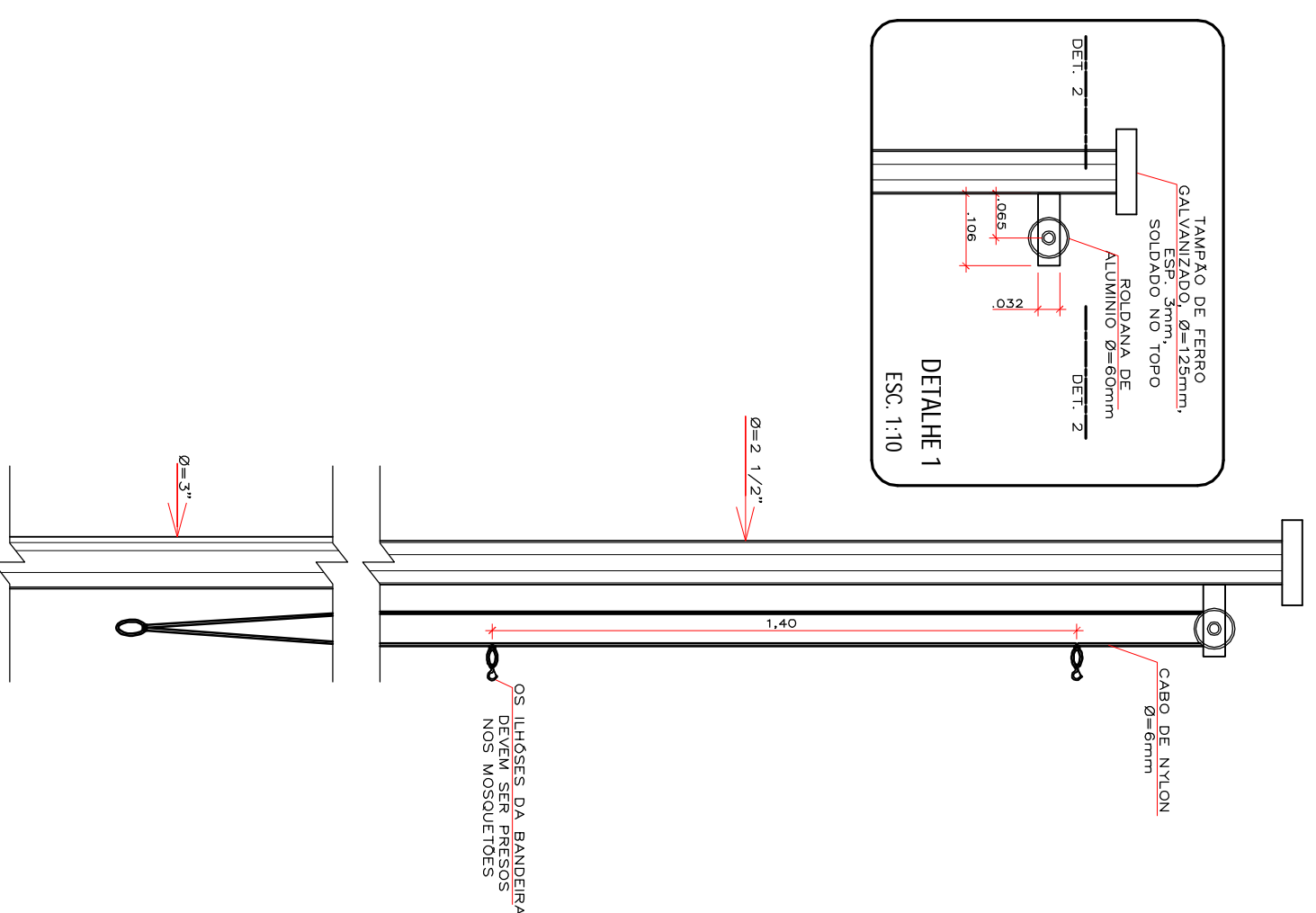
ALHE 2
K 25

**MASTRO - DETALHE DA AMARRAÇÃO
DO CABO**
ESC. 1:10

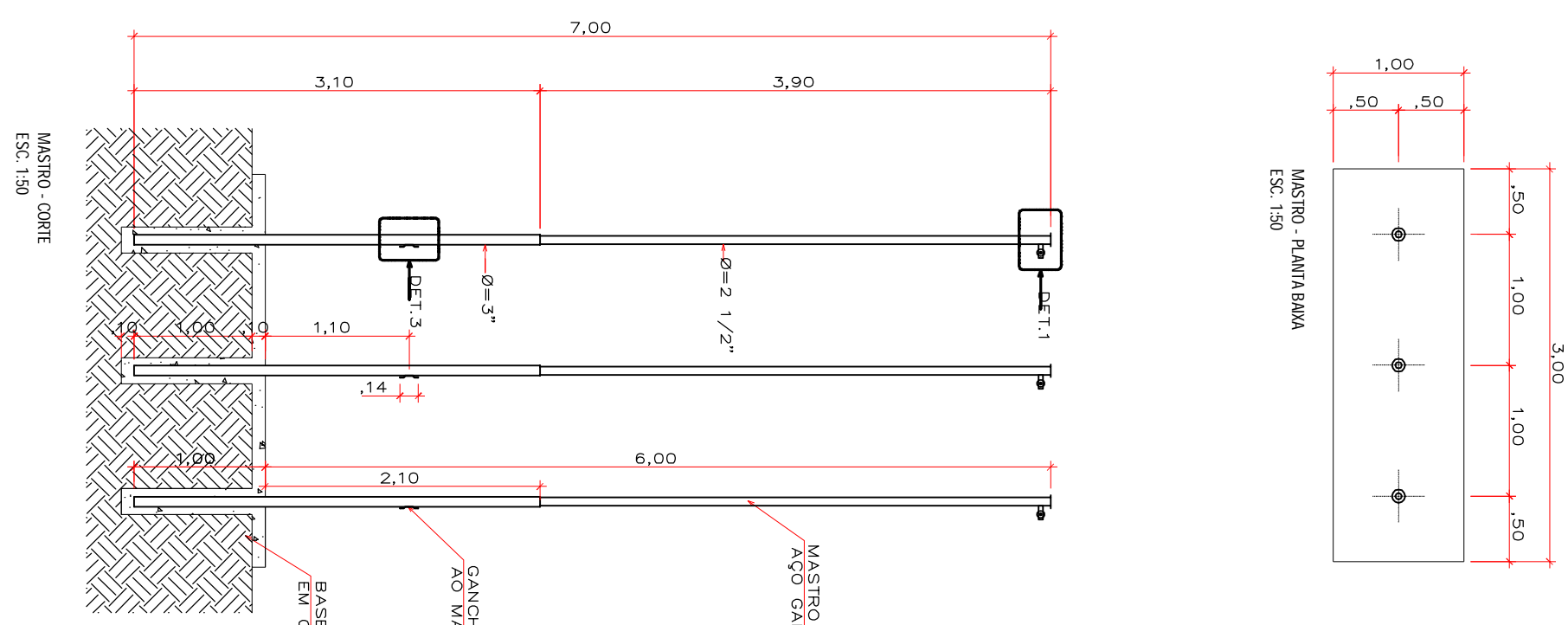

LEGENDA: PERFIS DE FERRO	
1	TUBO QUADRADO DE 1" X 1", e=1,90mm
2	TREFILADO "L" DE 1" X 1/8"
3	BARRA CHATA DE 3/4" X 1/8"
4	TREFILADO "T" DE 1" X 1/8"
5	CHAPA PERFURADA: e=1,0mm; EC=3,0mm; ØFURO = 2,0mm; AA=40%
6	PARAFUSO GALVANIZADO E BUCHA S6
7	REBITE MACIÇO 3/16" X 1/2"
8	REBITE MACIÇO 3/16" X 1"

LEGENDA: PERFIS DE FERRO

[illegible]